



BEST PLUMBING SPECIALTIES

800-448-6710 | www.BestPlumbingSpecialties.com

Model No.

99121054

Item No.



ADA Compliant

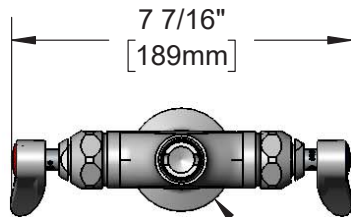

EZ-K
EasyInstall Kit
Converts Rigid Risers &
Nozzles For Use with
Swivel Outlet (Included)

Ø 2 1/4" [57mm]
Deck Flange

Swivel Outlet Accepts
Standard T&S Swing Nozzles
and EasyInstall Risers.

Quarter-Turn Eterna
Cartridges w/ Spring
Checks & Lever Handles
w/ Color Coded Indexes

2 5/16"
[58mm]

Mounting
Surface

3 7/8"
[99mm]

18" Flexible
Stainless Steel
Supply Hoses

Ø 1 1/8"
[29mm]

1 3/8"
[35mm]
Maximum
Thickness

Compression Fittings
for 5/8" O.D. Copper Tubing
(Remove Compression Nut
for 1/2" NPSM Male)

Rough-In Requirement:
Ø 1 1/2" [38mm] Mounting Hole

Product Specifications:

Single Hole Deck Mount Mixing Faucet, Quarter-Turn Eterna Cartridges w/ Spring Checks, Lever Handle & 18" Flexible Stainless Steel Supply Hoses w/ 1/2" NPSM Male Inlets, Less Nozzle

Product Compliance:

ASME A112.18.1 / CSA B125.1
NSF 61 - Section 9
NSF 372 (Low Lead Content)
ANSI A117.1 (ADA)

Drawn: DMH | Checked: JRM | Approved: JHB | Date: 05/05/17 | Scale: 1:4 | Sheet: 1 of 2



BEST PLUMBING SPECIALTIES

800-448-6710 | www.BestPlumbingSpecialties.com

Model No.

99121054

Item No.

ITEM NO.	SALES NO.	DESCRIPTION
1	99612172	Red Button Index, Press-in
2	99125316	Lever Handle (New Style)
3	99884095	Quarter-Turn Eterna Cartridge w/ Spring Check, Handle, Red Index & Screw, RTC
4	88089636	Quarter-Turn Eterna Cartridge w/ Spring Check, RTC
5	88089635	Quarter-Turn Eterna Cartridge w/ Spring Check, LTC
6	99884094	Quarter-Turn Eterna Cartridge w/ Spring Check, Handle, Blue Index & Screw, LTC
7	99254191	Lab Handle Screw
8	99612171	Blue Button Index, Press-in
9	71503	Lock Washer
10	99102387	Lock Nut
11	99162973	18" Flexible Supply Hose (2)

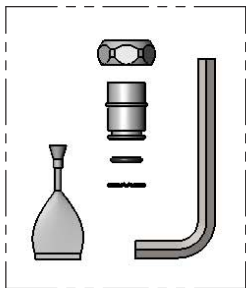
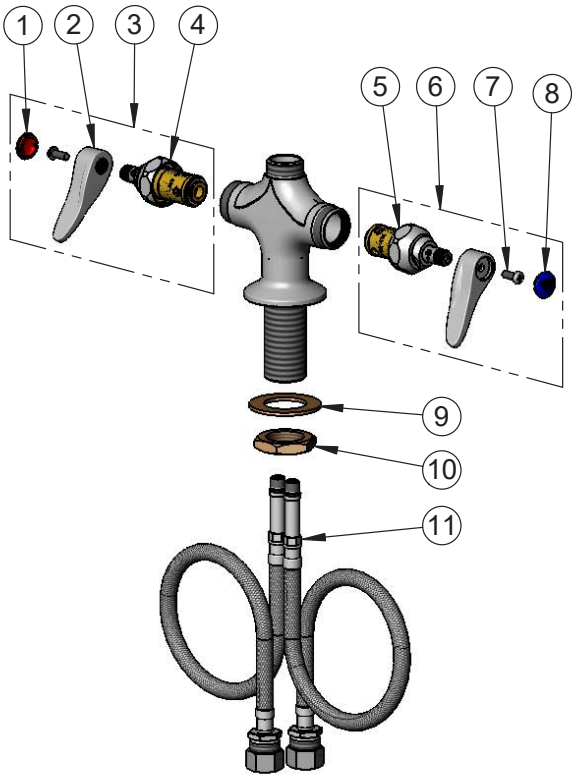

EZ-K
Converts Rigid Outlets to
EasyInstall for Use with
T&S Swivel Base Faucets

Product Specifications:

Single Hole Deck Mount Mixing Faucet, Quarter-Turn Eterna Cartridges w/ Spring Checks, Lever Handle & 18" Flexible Stainless Steel Supply Hoses w/ 1/2" NPSM Male Inlets, Less Nozzle

Product Compliance:

ASME A112.18.1 / CSA B125.1
NSF 61 - Section 9
NSF 372 (Low Lead Content)
ANSI A117.1 (ADA)

Drawn: DMH | Checked: JRM | Approved: JHB | Date: 05/05/17 | Scale: NTS | Sheet: 2 of 2